

## Miniature Compression Load Cell

Model XLC46



max.  
50,000  
lbs



Force

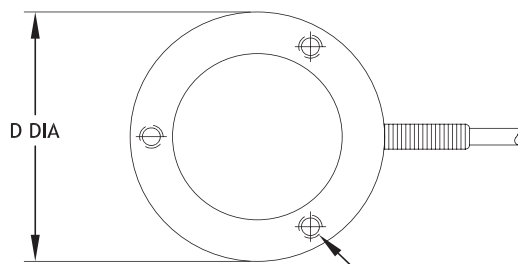
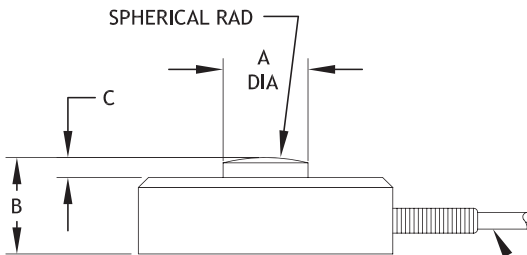

5FT OF 4-CONDUCTOR CABLE  
WIRING CODE:

White +Output  
Green -Output  
Black -Input  
Red +Input

E UNC THREAD X F DEEP,  
3 MOUNTING HOLES  
EQUALLY SPACED ON A G DIA BC

All dimensions are in inches, unless otherwise noted. Also available in metric units.



## Measuring ranges

- 0-5 to 0-50,000 lbs



## Features

- 0.25% Linearity
- Low Installation Height
- Ease of Installation
- mV/V Output



## Options

- Extended Compensated Temperature Range
- Overload Protection
- Inline Amplifier
- Bridge Resistance
- Cable Length



## Drawing

- 99-2658-0000

PERFORMANCE SPECIFICATIONS (FSO is Full Scale Output)		Capacity (lbs)	Ordering Example
EXCITATION	10 VDC, 15 VDC max	5	XLC46-0005
OUTPUT	2 mV/V Nominal	100	XLC46-0100
BRIDGE RESISTANCE	350 Ohms	1,000	XLC46-001K
LINEARITY	±0.25% FSO	7,500	XLC46-07K5
HYSTERESIS	±0.20% FSO	50,000	XLC46-050K
REPEATABILITY	±0.10% FSO		
ZERO BALANCE	±2% FSO		
OPERATING TEMP RANGE	-65 to +250°F (-54 to +121°C)		
COMPENSATED TEMP RANGE	+60 to +160°F (+15 to +71°C)		
THERMAL EFFECTS on Zero	±0.005% FSO/°F		
on Span	±0.01% Reading/°F		
SAFE OVERLOAD	150% of Capacity		
ULTIMATE OVERLOAD	300% of Capacity		
CASING MATERIAL	Stainless Steel		

Ranges (lbs)	D	A	B	C	E	F	G
0-5 to 0-100	1.00	.21	.62	.05	4-40	.22	.750
0-250 to 0-2,000	1.25	.32	.39	.07	6-32	.19	1.000
0-3,000 to 0-5,000	1.50	.43	.63	.08	6-32	.25	1.250
0-7,500 to 0-15,000	1.75	.43	.63	.08	6-32	.25	1.500
0-20,000 to 0-30,000	2.00	.60	1.00	.12	6-32	.25	1.625
0 - 50,000	3.00	.78	1.50	.18	6-32	.25	2.375