



**MELT PRESSURE
TRANSDUCERS & TRANSMITTERS**

300 Industrial Drive, Grand Island, NY 14072 USA
Tel. (716)775-8830 • Fax (716)775-8020 • sales@gp50.com • www.gp50.com

Product Specification Sheet

FLANGE MOUNTED LOW PRESSURE TRANSDUCER/TRANSMITTER

Models 130, 230, 330

131, 231, 331 with FX/FY option

MODELS 130, 230, 330

These are the rigid stem versions of GP:50's plastic melt pressure transducers. Standard length is 3.65 inches, although they may be ordered in longer or shorter lengths to accommodate individual needs (See outline drawing & close up). The limiting minimums may be the die temperature and environment which must jointly combine to restrict the electronics and sensor from exceeding 180°F.



***REFER TO APPENDIX A
FOR WIRING CODES***

FEATURES:

- All-welded, stainless steel construction
- State-of-the-art circuitry allows heavier diaphragm and increase fatigue life
- Standard options for every requirement
- Zero & Span controls, approximately $\pm 20\%$ FSO (2XX + 3XX only)

PRESSURE RANGES:

- From 0-25 through 0-1,000 psig (See ordering guide)

ACCURACY:

- 0.5% FSO

MODEL 30-FY

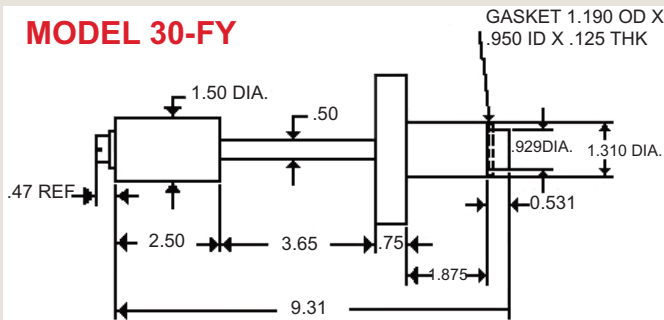

GASKET 1.190 OD X .950 ID X .125 THK

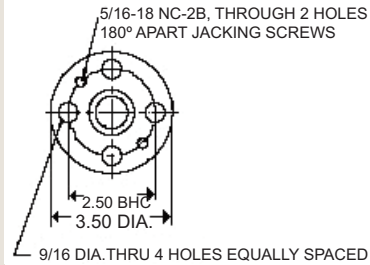

MODEL 30-FX

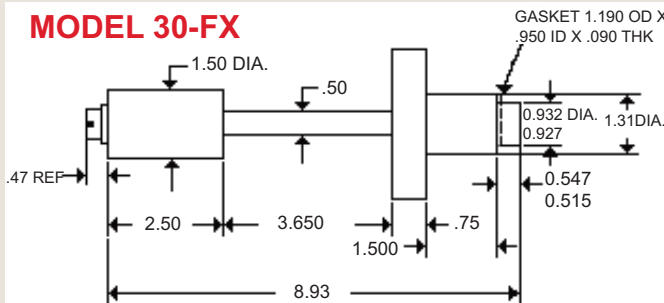

GASKET 1.190 OD X .950 ID X .090 THK

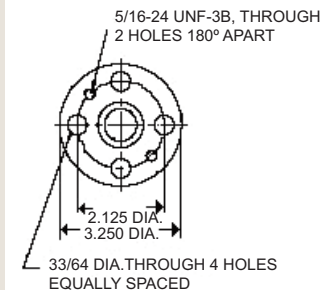

GP:50 reserves the right to make product improvements and amendments to the product specifications stated throughout this brochure without prior notification. Please contact the factory on all critical dimensions and specifications for verification.



MELT PRESSURE TRANSDUCERS & TRANSMITTERS

300 Industrial Drive, Grand Island, NY 14072 USA
Tel. (716)775-8830 • Fax (716)775-8020 • sales@gp50.com • www.gp50.com

MODELS 131, 231, 331

The flexible tube version of the product line provides the ultimate in thermal isolation for those demanding applications reaching 750°F. Models 131, 231, & 331 come with an 18 inch length of flexible capillary tubing protected with a SST armored jacket. This flexible capillary can be provided in shorter or longer lengths.

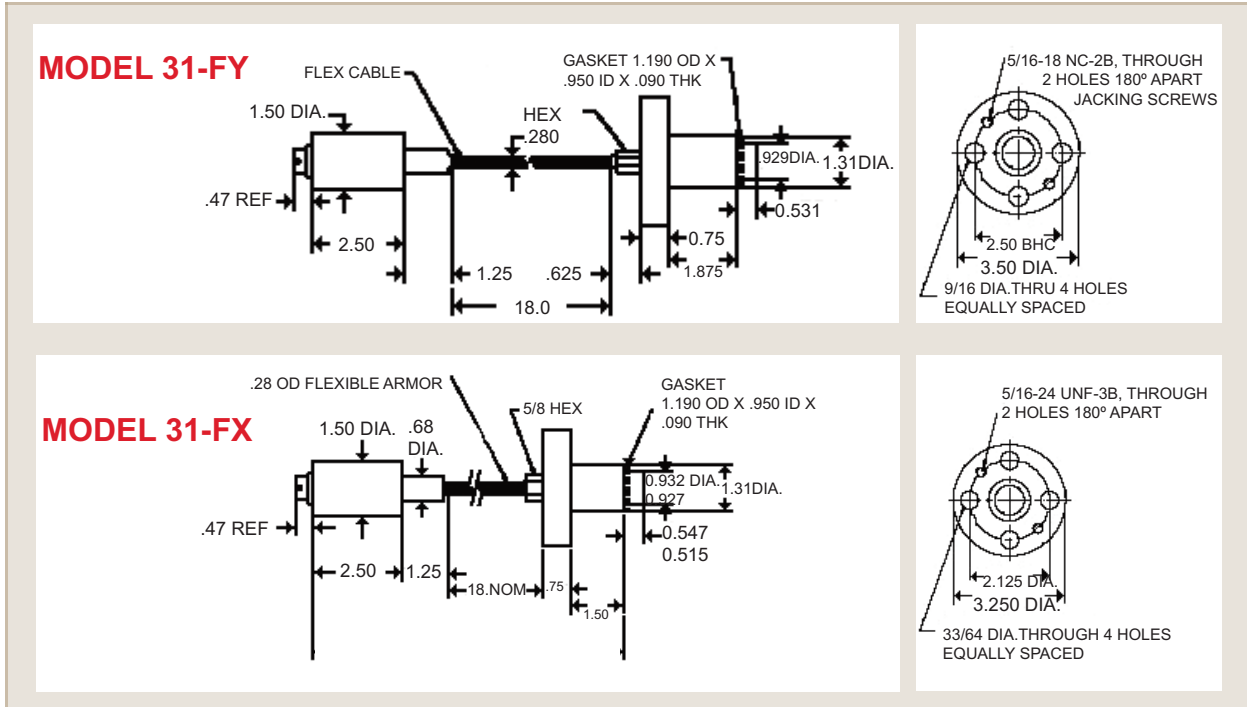

ORDERING GUIDE

Model: X 3X - XX - FX / XX / XX / XX / XX

ELECTRICAL OUTPUT	
1	3.33 mV/V
2	0-5 Vdc
3	4-20 mA

BASE MODEL	
0	Rigid Stem Only
1	Rigid Stem and Flex

PRESSURE RANGE		
PO	25 PSI	UL 2 BAR
PT	30 PSI	UM 3 BAR
PV	50 PSI	UN 5 BAR
PX	75 PSI	UP 7.5 BAR
PZ	100 PSI	UQ 10 BAR
RB	150 PSI	UR 15 BAR
RD	200 PSI	US 20 BAR
RE	250 PSI	UT 30 BAR
RF	300 PSI	UV 50 BAR
RH	500 PSI	UX 75 BAR
RJ	600 PSI	SZ Custom
RK	750 PSI	
RM	1,000 PSI	

FLANGE TYPE	
X	3.25 Diameter Flange
Y	3.50 Diameter Flange

CAPILLARY TUBE LENGTH	
Blank	18 Inch (457.2mm) Flex
HS	9 Inch (228.6mm) Flex
HY	12 Inch (304.8mm) Flex
HV	24 Inch (609.6mm) Flex
GT	30 Inch (762mm) Flex

DIAPHRAGM OPTIONS	
Blank	15-5 PH Diaphragm
GP	Hastelloy C-276 Diaphragm & Threads
GQ	Boron Hardened Diaphragm
JW	Titanium Nitride Coated Diaphragm & Threads
QS	Diamond Coating (DLC)

FILL TYPES	
Blank	Mercury (Standard - Included)
QJ	Nak Fill (750°F Max)
GW	Nak Fill with Inconel Diaphragm (1000°F Max)
GV	Silicon Oil Fill (500°F Max)
GX	Mineral Oil Fill (500°F Max)

CONNECTOR OPTIONS	
Blank	6-Pin Bendix (PTIH-10-6P)
CC	8-Pin Bendix (PCO2E-12-8P)
CF	1/2" NPT (M) Thread with 36" Leads

* Other Options Available - Consult Factory



**MELT PRESSURE
TRANSDUCERS & TRANSMITTERS**

300 Industrial Drive, Grand Island, NY 14072 USA

Tel. (716)775-8830 • Fax (716)775-8020 • sales@gp50.com • www.gp50.com

Specifications reflect standard product, improved performance/mechanical options available. Modifications may alter specs, consult factory for more information.

Full Scale Pressure Ranges	See ordering guide	
Accuracy	Static Error Band (Non-linearity, Hysteresis, Non-repeatability) ± 0.5% FSO(RSS)	
Material in Contact with Pressure Media	316 stainless steel	
Proof Pressure	2 times full scale pressure range	
Temperature Limits	750°F (400°C) Standard fill 176°F (80°C)	
Temperature Effects		
From Diaphragm		
Zero	2 psi/100°F	
From Strain Gauge Housing		
Zero	Less than ± 1.0% FSO/100°F (± 2.0% FSO/100°C)	
Span	Less than ± 1.0% FSO/100°F (± 2.0% FSO/100°C)	
Electricals	Excitation Voltage	Output at 70° F
(Model 130/131)	3.5-15 Vdc	3.33 mV/V ± 2% FSO
(Model 230/231)	9-40 Vdc	5.0 Vdc ±2% FSO
(Model 330/331)	9-36 Vdc	4-20 mA ±2% FSO
Zero Balance		
(Model 130/131)	0.0 mV/V ±5% FSO at 70°F, vertical tip down	
(Model 230/231)	0.0 Vdc ±5% FSO at 70°F, vertical tip down	
(Model 330/331)	4.0 mA ±5% FSO at 70°F, vertical tip down	
Input Impedance		
(Model 130/131)	350 ohm, nominal	
Input Current		
(Model 230/231)	8 mA nominal	
Load Impedance		
(Model 130/131)	50,000 ohms minimum for less than 0.1% FSO attenuation	
(Model 330/331)	1350 ohms max. at 36 Vdc & 750 ohms at 24 Vdc	
Output Current		
(Model 230/231)	2.0 mA maximum for less than 0.1% FSO attenuation	
Range Cal. Signal	80% ±0.5% FSO standard	
Connections		
Pressure	3.25" OD Flange (FX option) 3.50" OD Flange (FY option)	
Electrical	PTIH-10-6P, standard PT06A-10-6S (SR), standard mate (not included) See options.	
Enclosed Materials	316 stainless steel	
Mounting Torque	110 inch pounds, maximum	
Identification	Etched stainless steel nameplate welded to body.	